

# SUN ODYSSEY 380

Princess Anja (2024)



Pollen Maritime AS • Martin Linges Vei 25 • Fornebu • Norge

Telefon: +47 41 197 474

E-post: [booking@holiday-yacht-charter.com](mailto:booking@holiday-yacht-charter.com)

Web: [holiday-yacht-charter.com](http://holiday-yacht-charter.com)

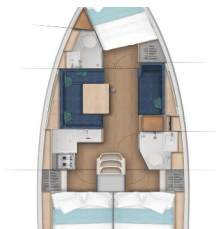

|                  |                                |
|------------------|--------------------------------|
| Yachtbase        | Pula, Marina Polesana, Kroatia |
| Yacht ID         | 10205                          |
| Yachtmerker      | Jeanneau                       |
| Yacht Yacht Navn | Princess Anja                  |
| Produksjonsår    | 2024                           |
| Lengde           | 11.22 M                        |
| Kabin/Kabiner    | 3                              |
| Køyer            | 6 + 2                          |
| Personer         | 8                              |
| WC/dusj          | 2                              |

**DEKK:** Badeplattform, Badestige, Bimini top, Cockpit bord, Cockpit/akter, dusj ute, Lensepumpe - Mekanisk, Sprayhood, Teak cockpit

**ELEKTRISK:** Aircondition, Batteriader, Batterivakt, Solpaneler, USB uttak, Varme

**INTERIØR:** Elektrisk toalett, Elektriske vifter, LED lys, Setetrekk

**KOMFORT:** Cockpit puter

**NAVIGASJON:** Autopilot, Baugpropell, GPS kartplotter, Raymarine navsystem (Tridata, ekko, vind)

**SIKKERHET:** VHF radio

**UNDERHOLDNING:** FUSION lydsystem, Høytalere inne, Radio, USB, Bluetooth

# PRIS OG TILGJENGELIGHET

Sun Odyssey 380 Princess Anja (2024)



|  |  |  |  |
|--|--|--|--|
| <b>25.04. - 02.05.2026</b><br>1.073 € <del>1.950 €</del> | <b>02.05. - 09.05.2026</b><br>1.183 € <del>2.150 €</del> | <b>09.05. - 16.05.2026</b><br>1.183 € <del>2.150 €</del> | <b>16.05. - 23.05.2026</b><br>1.540 € <del>2.800 €</del> |
| <b>23.05. - 30.05.2026</b><br>Bestilt                    | <b>30.05. - 06.06.2026</b><br>Bestilt                    | <b>06.06. - 13.06.2026</b><br>2.663 € <del>3.550 €</del> | <b>13.06. - 20.06.2026</b><br>Bestilt                    |
| <b>20.06. - 11.07.2026</b><br>Bestilt                    | <b>11.07. - 18.07.2026</b><br>Bestilt                    | <b>18.07. - 25.07.2026</b><br>3.068 € <del>4.090 €</del> | <b>25.07. - 01.08.2026</b><br>3.068 € <del>4.090 €</del> |
| <b>01.08. - 08.08.2026</b><br>3.068 € <del>4.090 €</del> | <b>08.08. - 15.08.2026</b><br>3.068 € <del>4.090 €</del> | <b>15.08. - 22.08.2026</b><br>3.068 € <del>4.090 €</del> | <b>22.08. - 29.08.2026</b><br>2.850 € <del>3.800 €</del> |
| <b>29.08. - 05.09.2026</b><br>Bestilt                    | <b>05.09. - 12.09.2026</b><br>Bestilt                    | <b>12.09. - 19.09.2026</b><br>Bestilt                    | <b>19.09. - 26.09.2026</b><br>2.063 € <del>2.750 €</del> |
| <b>26.09. - 03.10.2026</b><br>1.875 € <del>2.500 €</del> | <b>03.10. - 10.10.2026</b><br>1.575 € <del>2.100 €</del> | <b>10.10. - 17.10.2026</b><br>1.275 € <del>1.700 €</del> | <b>17.10. - 24.10.2026</b><br>1.275 € <del>1.700 €</del> |
| <b>24.10. - 31.10.2026</b><br>1.275 € <del>1.700 €</del> | <b>31.10. - 07.11.2026</b><br>1.275 € <del>1.700 €</del> | <b>08.11. - 31.12.2026</b><br>Bestilt                    |  |