

# BALI 4.1

Avaler (2020)



Pollen Maritime AS • Martin Linges Vei 25 • Fornebu • Norway

Phone: +47 41 197 474

E-mail: [booking@holiday-yacht-charter.com](mailto:booking@holiday-yacht-charter.com)

Web: [holiday-yacht-charter.com](http://holiday-yacht-charter.com)

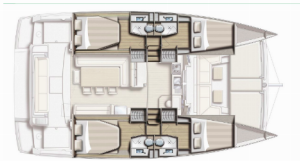

Yacht Base	Dubrovnik, Komolac, ACI Marina Dubrovnik, Croatia
Yacht ID	6852
Yacht Brands	Catana
Yacht Name	Avaler
Production Year	2020
Length	12.35 M
Cabins	4
Berths	8 + 2
Persons	10
WC/Shower	4

**COMFORT:** Bed linen, Cockpit cushions, Sun mattresses

**DECK:** Bathing platform, Bimini top, Cockpit table, Cockpit/stern, outside shower, Dinghy, Flybridge, Forward cockpit

**ENTERTAINMENT:** Outdoor speakers, Radio CD player

**GALLEY:** Freezer, Hot water, Kitchen utensils (Galley equipment, cutlery), Oven, Refrigerator, Stove

**NAVIGATION:** Autopilot, GPS chart plotter, Navigation (Nautical) charts and nautical guide, Pilot book, Tridata

**SAFETY:** VHF radio

**SAILS:** Electric primary winch

**YACHT ELECTRICS:** Battery charger, Inverter

## PRICE AND AVAILABILITY

Bali 4.1 Avaler (2020)



<b>25.04. - 02.05.2026</b> 1.584 € <del>1.980€</del>	<b>02.05. - 09.05.2026</b> 1.584 € <del>1.980€</del>	<b>09.05. - 16.05.2026</b> 1.776 € <del>2.220€</del>	<b>16.05. - 23.05.2026</b> 2.352 € <del>2.940€</del>
<b>23.05. - 30.05.2026</b> 2.736 € <del>3.420€</del>	<b>30.05. - 06.06.2026</b> Not available	<b>06.06. - 13.06.2026</b> Not available	<b>13.06. - 20.06.2026</b> Not available
<b>20.06. - 27.06.2026</b> Not available	<b>27.06. - 04.07.2026</b> Not available	<b>04.07. - 11.07.2026</b> Not available	<b>11.07. - 18.07.2026</b> 5.744 € <del>7.180€</del>
<b>18.07. - 25.07.2026</b> 5.984 € <del>7.480€</del>	<b>25.07. - 01.08.2026</b> 5.984 € <del>7.480€</del>	<b>01.08. - 08.08.2026</b> Not available	<b>08.08. - 15.08.2026</b> 5.776 € <del>7.220€</del>
<b>15.08. - 22.08.2026</b> Not available	<b>22.08. - 29.08.2026</b> 5.456 € <del>6.820€</del>	<b>29.08. - 05.09.2026</b> 5.456 € <del>6.820€</del>	<b>05.09. - 19.09.2026</b> Not available
<b>19.09. - 26.09.2026</b> Not available	<b>26.09. - 03.10.2026</b> 3.216 € <del>4.020€</del>	<b>03.10. - 10.10.2026</b> Not available	<b>10.10. - 17.10.2026</b> Not available
<b>17.10. - 24.10.2026</b> 1.472 € <del>1.840€</del>	<b>24.10. - 31.10.2026</b> 1.472 € <del>1.840€</del>	<b>31.10. - 07.11.2026</b> 1.472 € <del>1.840€</del>	<b>07.11. - 14.11.2026</b> 1.472 € <del>1.840€</del>
<b>14.11. - 21.11.2026</b> 1.472 € <del>1.840€</del>	<b>21.11. - 28.11.2026</b> 1.472 € <del>1.840€</del>	<b>28.11. - 05.12.2026</b> 1.472 € <del>1.840€</del>	

## PRICE AND AVAILABILITY

Bali 4.1 Avaler (2020)



**05.12. - 12.12.2026**

1.472 € ~~1.840 €~~

**12.12. - 19.12.2026**

1.472 € ~~1.840 €~~

**19.12. - 26.12.2026**

1.472 € ~~1.840 €~~