

LAGOON 400 S2

Yolamare (2014)



Pollen Maritime AS • Martin Linges Vei 25 • Fornebu • Norway

Phone: +47 41 197 474

E-mail: booking@holiday-yacht-charter.com

Web: holiday-yacht-charter.com

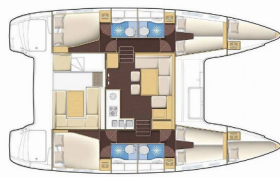

| | |
|-----------------|--|
| Yacht Base | Marina Tehnomont Veruda, Pula, Croatia |
| Yacht ID | 15967 |
| Yacht Brands | Lagoon |
| Yacht Name | Yolamare |
| Production Year | 2014 |
| Length | 11.97 M |
| Cabins | 4 + 2 |
| Berths | 8 + 2 + 2 |
| Persons | 12 |
| WC/Shower | 4 |

COMFORT: Cockpit cushions

DECK: Anchor line, Anchor swivel, Bimini top, Black ball, Black conus, Boat hook, Bosun's chair (Safe seat) (boatswain's chair), Canister for water, Cockpit table, Cockpit/stern, outside shower, Davit, Dinghy, Dinghy (byboat) pump, Electric anchor windlass, Fenders, Gangway, Impeller, V-belt, oilfilter, Jerry cans for fuel, Main anchor, Mooring ropes, Plastic bucket, Repair box for dinghy, Round/globular fender, Spare anchor (Reserve, Auxiliary anchor), Spotlight / Headlights, Teak cockpit, Water hose

ENTERTAINMENT: Outdoor speakers, Radio

GALLEY: Gas bottles, Hot water, Kitchen utensils (Galley equipment, cutlery), Refrigerator

INTERIOR: Barometer, Clock, Lowerable salon table

NAVIGATION: Autopilot, GPS chart plotter - cockpit, Hand bearing compass, Harbour guides, Navigation (Nautical) charts and nautical guide, Navigation set, Radar reflector, Spyglass, Windex

SAFETY: Distress signals, Fire extinguisher, First aid kit, Flashlight, Fog horn, Life belts (Safety harness), Life buoy + Flashing light, Life jackets, Liferaft, Set of tools, VHF radio, Wire (shroud) cutter

SAILS: Electric winch, Lazy bag, Lazy jacks

YACHT ELECTRICS: Battery charger, Heating, Inverter, Shore connection 220 V, Solar panels, USB sockets

PRICE AND AVAILABILITY

Lagoon 400 S2 Yolamare (2014)



| | | | |
|--|--|--|--|
| 25.04. - 02.05.2026 Not available | 02.05. - 09.05.2026 1.645 € 2.350 € | 09.05. - 16.05.2026 1.890 € 2.700 € | 16.05. - 23.05.2026 2.060 € 2.575 € |
| 23.05. - 30.05.2026 Not available | 30.05. - 03.06.2026 Not available | 03.06. - 13.06.2026 Not available | 13.06. - 27.06.2026 Not available |
| 27.06. - 04.07.2026 Not available | 04.07. - 18.07.2026 Not available | 18.07. - 25.07.2026 Not available | 25.07. - 08.08.2026 Not available |
| 08.08. - 15.08.2026 Not available | 15.08. - 22.08.2026 Not available | 22.08. - 29.08.2026 Not available | 29.08. - 05.09.2026 Not available |
| 05.09. - 12.09.2026 Not available | 12.09. - 19.09.2026 Not available | 19.09. - 26.09.2026 2.760 € 3.450 € | 26.09. - 03.10.2026 2.760 € 3.450 € |
| 03.10. - 10.10.2026 1.960 € 2.450 € | 10.10. - 17.10.2026 1.960 € 2.450 € | 17.10. - 24.10.2026 1.720 € 2.150 € | 24.10. - 31.10.2026 1.680 € 2.100 € |
| 31.10. - 07.11.2026 1.728 € 2.160 € | 07.11. - 14.11.2026 2.600 € 3.250 € | 14.11. - 21.11.2026 2.600 € 3.250 € | 22.11. - 31.12.2026 Not available |